

GENERATOR (SWITCH-MODE) - MG030KG-511KE

Categories: Microwave generators



BILDERGALERIE

Outline Dimensions (mm(inch))

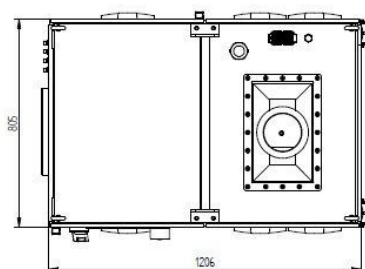
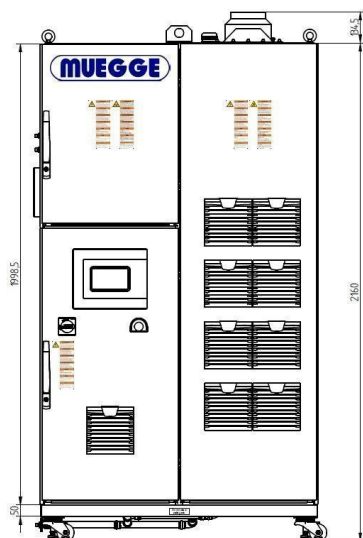

ADDITIONAL INFORMATION

Typ	Generator
Frequency [MHz]	915
Output Power [W]	30000
Line connection	3~ (L1 / L2 / L3 / PE)
Control circuit connection [V]	-
Line Voltage [V]	480
Mains voltage control circuit [V]	-
Line Frequency [Hz]	50 / 60
Cooling	Air / Water
Pulse output power max [W]	-
Front-Panel (HMI)	-
Interface	Control panel
Interface 2	EtherCAT
Interface 3	A/D
Interface 4	-
Interface 5	-
Width [mm (inch)]	1206 (47,48)
Height [mm (inch)]	2160 (85,04)
Depth [mm (inch)]	805 (31,69)
Protection	IP54
Output Connection Type	WR 975
Output Connection	Waveguide
Isolator	No
Power-Supply	Switch-Mode