

MAGNETRON - MB2533A-110DG

Categories: Magnetrons

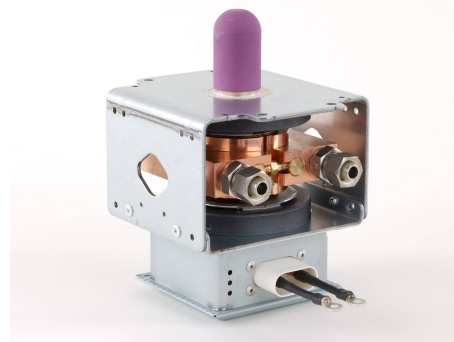

BILDERGALERIE

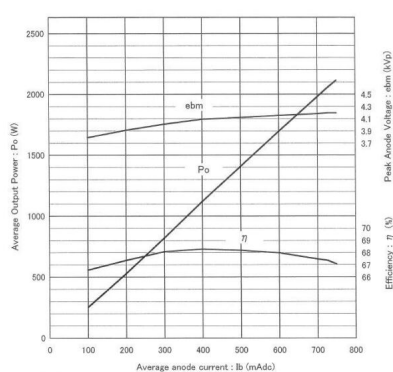

Performance Chart

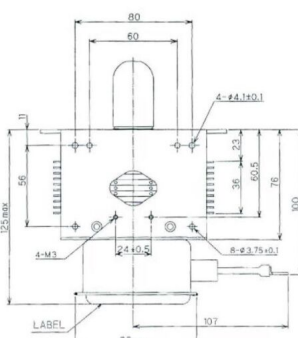

Tube Outline Dimensions (mm(inch))

Tube Outline Dimensions (mm(inch))

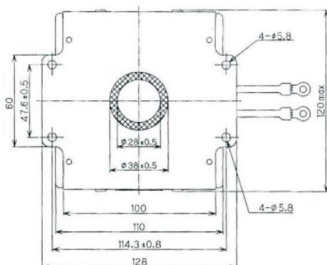

ADDITIONAL INFORMATION

Typ	Magnetron
OEM Item Number	MB2533A -110DG
Output Power CW [W]	2000
Frequency [MHz]	2450
ISM Band	S-Band
Cooling	water-cooled
Orientation of HV and cooling connectors	0°
Fastening / Studs	4 x Through-hole 5,8 (no studs)
Orientation HV to fastening	0°
Magnet	Packaged magnet
Cooling Connector Type	Pipe socket with union nut 3/8" Female Thread
Temperature sensor	-