

GENERATOR (SWITCH-MODE) - MG050KG-511KE

Categories:



BILDERGALERIE

Outline Dimensions (mm(inch))

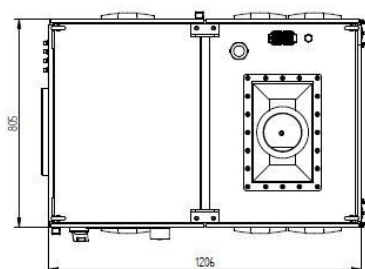
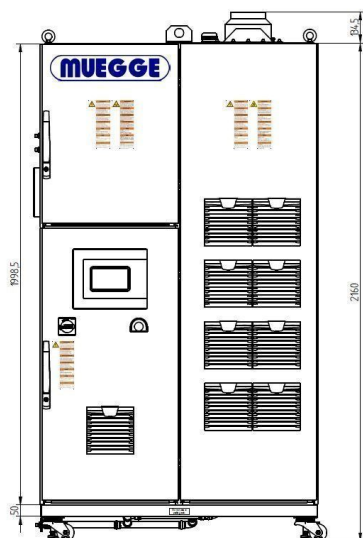

ZUSÄTZLICHE INFORMATIONEN

Art	
Frequenz [MHz]	915
CW [W]	50000
	3~ (L1 / L2 / L3 / PE)
	-
[V]	480
[V]	-
[Hz]	50 / 60
	/
[W]	-
(HMI)	-
2	EtherCAT
3	A/D
4	-
5	-
[mm ()]	1206 (47,48)
[mm ()]	2160 (85,04)
[mm ()]	805 (31,69)
	IP54
	WR 975