

Waveguide Transition, Tapered

GERLING

Model GA2006
Model GA2007
Model GA2017

GAE offers a series of high power tapered waveguide transitions that deliver high performance at high power levels. Each model in the series is designed using a theoretically optimal taper length to achieve waveguide transitioning with minimal VSWR. The dip brazed aluminum construction assures durability while a chemical conversion coating provides protection from corrosion.

General Specifications:

Frequency	2450 MHz +/- 30 MHz
Input Power	10 kW continuous max.
Input VSWR	1.05 max.
Insertion Loss	.02 dB max
Material	6061-T6 aluminum
Construction	Dip braze per MIL-B-7883C, Type 5, Grade B
Finish	Clear chemical film per MIL-C-5541, Class 1A

Options:

- ◆ Threaded inserts or studs on flange hole patterns (any combination)
- ◆ Flange interlock switches
- ◆ Alternate finish

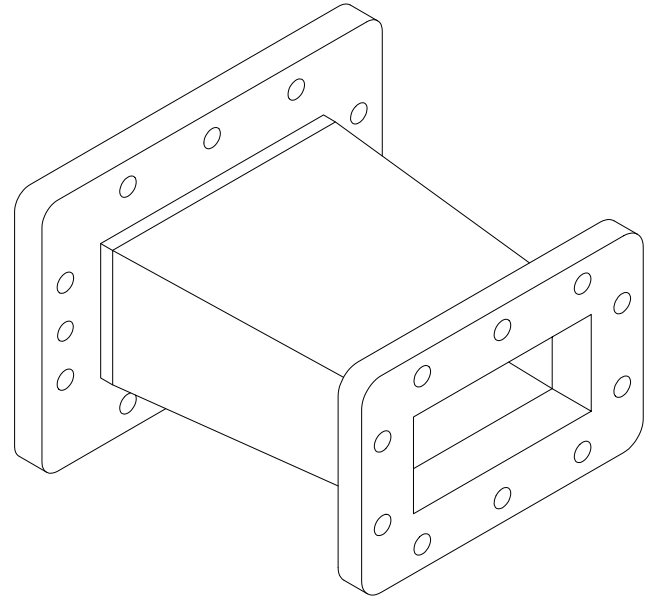

Model GA2006

	GA2006	GA2007	GA2017
A	5.04 [128]	4.60 [117]	4.35 [110,5]
B	3.75 [95,3]	4.19 [106,4]	4.19 [106,4]
C	5.44 [138,2]	6.34 [161,0]	6.34 [161,0]
D	3.00 [76,2]	3.00 [76,2]	3.75 [95,3]
E	4.50 [114,3]	4.50 [114,3]	5.44 [138,2]
F	WR340 (UG554/U)	WR430 (UG437B/U)	WR430 (UG437B/U)
G	CPR284 (UG1725/U)	CPR284 (UG1725/U)	WR340 (UG554/U)

ALL FLANGE BOLT HOLES ϕ .265 [6,7] (TAPPED HOLES OPTIONAL).

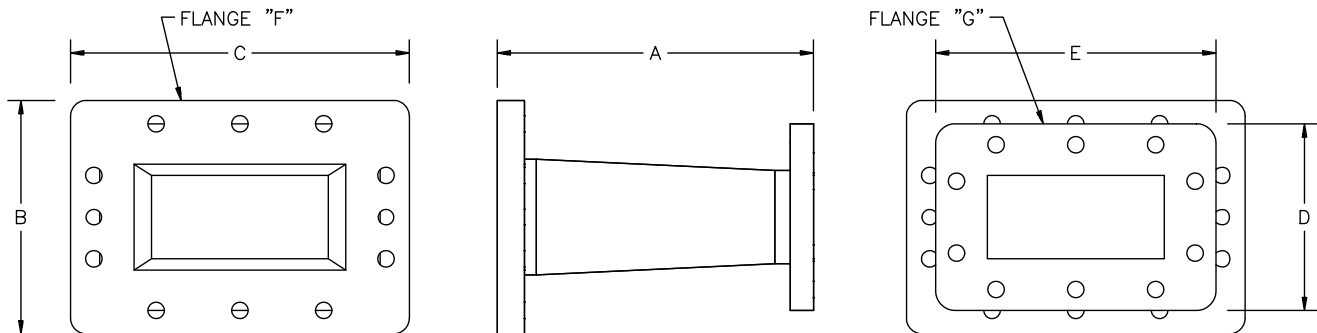

GERLING APPLIED ENGINEERING, INC.
 (a Muegge GmbH company)

© 2003 Gerling Applied Engineering, Inc.
 PO Box 580816 • Modesto, CA 95358 • USA
 Phone: +1-209-527-8960 • Fax: +1-209-527-5385
 E-mail: sales@2450MHz.com • Web: www.2450MHz.com