

Waveguide Adapter, Type N Coax

GERLING

Model GA2011
Model GA2012

GAE offers a series of high power waveguide to coax transitions that deliver high performance at high microwave power levels. Each model in the series utilizes the classical cross-bar method of terminating the coaxial center conductor, thus minimizing or eliminating the voltage breakdown common with non-terminated designs. The power rating is limited only by the rating of the coaxial cable (provided by the customer) attached to the Type N connector, which in most cases does not exceed 1 kW.

General Specifications:

Frequency	2450 MHz +/- 20 MHz
Input Power	1 kW continuous max. (output to matched load)
Waveguide	GA2011: WR340 (RG113/U) GA2012: WR430 (RG105/U)
Waveguide Flange	GA2011: UG1713/U GA2012: UG1711/U
Coax Connector	Type N female
Input VSWR	1.2 max.
Insertion Loss	.13 dB max
Construction	Aluminum waveguide body; Brass coax connector and center conductor
Finish	Chemical conversion coating

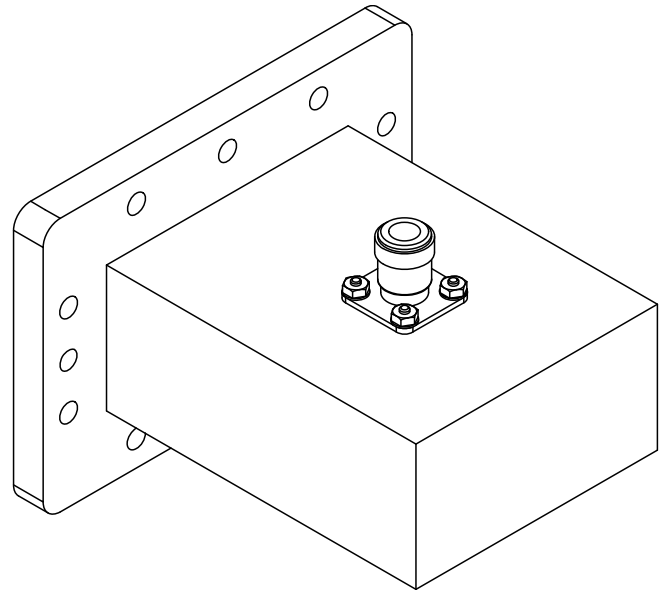

Options:

- ◆ Threaded inserts or studs on flange (any combination)
- ◆ Flange interlock switch

	GA2011	GA2012
WAVEGUIDE	WR340	WR430
A	5.44 [138]	6.34 [161]
B	3.75 [95]	4.19 [106]
C	3.56 [90]	4.46 [113]
D	1.86 [47]	2.31 [59]
E	UG1713/U	UG1711/U

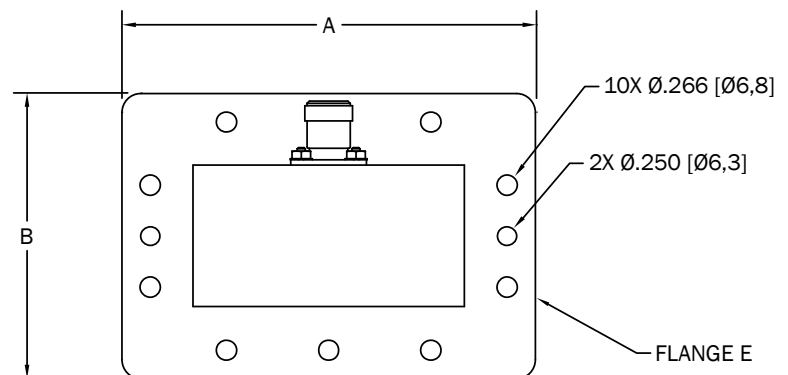
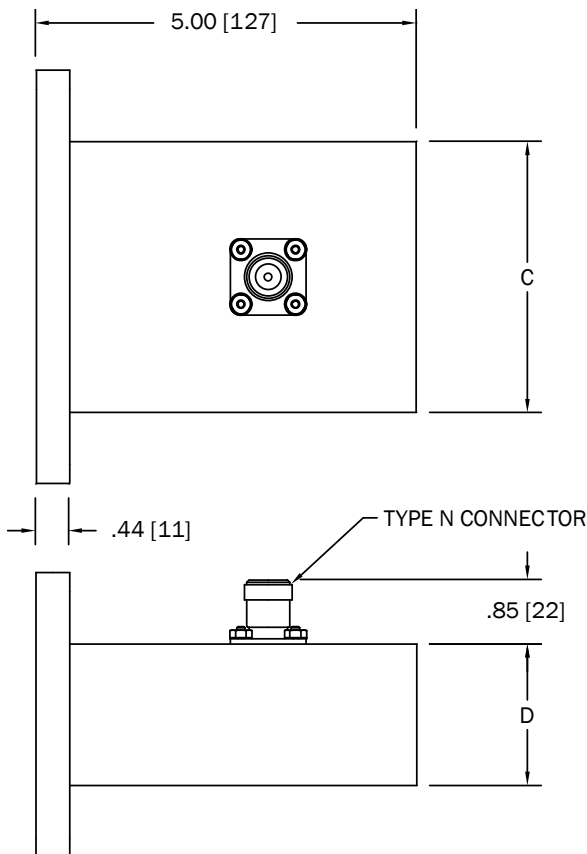

GERLING APPLIED
ENGINEERING, INC.

© 2003-2016 Gerling Applied Engineering, Inc.
PO Box 580816 • Modesto, CA 95358 • USA
Phone: +1-209-527-8960 • Fax: +1-209-527-5385
E-mail: sales@2450MHz.com • Web: www.2450MHz.com