

MAGNETRON - MW-52030-002

Kategorie: Magnetrons

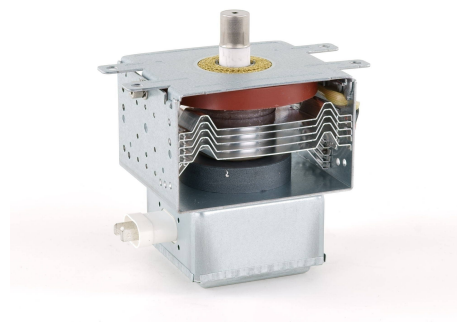

BILDERGALERIE

Tube Outline Dimensions (mm)(inch)

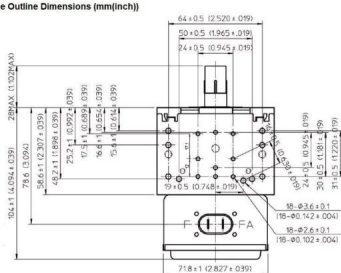

Tube Outline Dimensions (mm)(inch)

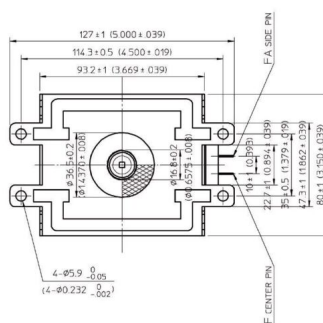

ZUSÄTZLICHE INFORMATIONEN

| | |
|------------------------------------|----------------------------|
| Art | Magnetron |
| Hersteller-Artikel Nr. | MW-52030-002 |
| Leistung CW [W] | 900 |
| Frequenz [MHz] | 2450 |
| ISM Band | S-Band |
| Kühlungsart | Luftgekühlt |
| Ausrichtung Kühler | 90° |
| Befestigungsmöglichkeit | 4x M5 Bolzen (Studs) |
| Richtung Befestigungsbolzen | 0° |
| Magnet | E-Magnet + Permanentmagnet |
| Kühlwasser Anschluss | - |
| Temperaturwächter | 100 °C (212 °F) |