

# GENERATOR (SWITCH-MODE) - MG050KG-511KE

Category: Microwave generators



## BILDERGALERIE

Outline Dimensions (mm(inch))

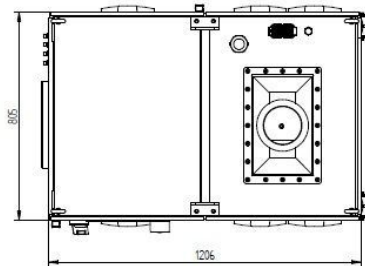
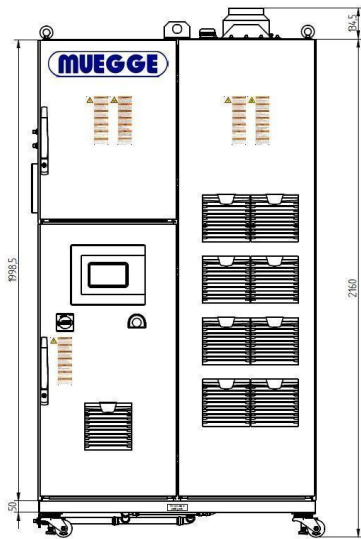

## ADDITIONAL INFORMATION

<b>Typ</b>	Generator
<b>Frequency [MHz]</b>	915
<b>Output Power CW [W]</b>	50000
<b>Line connection</b>	3~ (L1 / L2 / L3 / PE)
<b>Control circuit connection [V]</b>	-
<b>Line Voltage [V]</b>	480
<b>Mains voltage control circuit [V]</b>	-
<b>Line Frequency [Hz]</b>	50 / 60
<b>Cooling</b>	Air / Water, Air / Water
<b>Pulse output power max [W]</b>	-
<b>Front-Panel (HMI)</b>	-
<b>Interface</b>	Control panel
<b>Interface 2</b>	EtherCAT
<b>Interface 3</b>	A/D
<b>Interface 4</b>	-
<b>Interface 5</b>	-
<b>Width [mm (inch)]</b>	1206 (47,48)
<b>Height [mm (inch)]</b>	2160 (85,04)
<b>Depth [mm (inch)]</b>	805 (31,69)
<b>Protection Class</b>	IP54
<b>Output Connection Type</b>	WR 975
<b>Output Connection</b>	Waveguide
<b>Isolator</b>	No
<b>Power-Supply</b>	Switch-Mode