

HOHLLEITER DISTANZSTÜCK - MW3002E-230ED

Category: Waveguide components

Outline Dimensions (mm(inch))

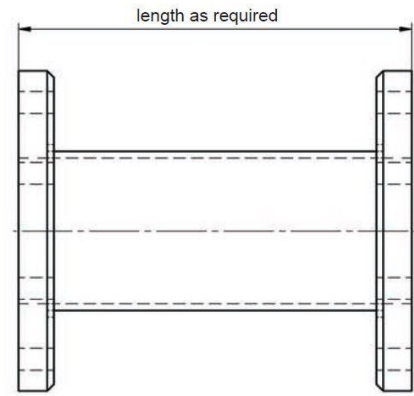

BILDERGALERIE

Outline Dimensions (mm(inch))

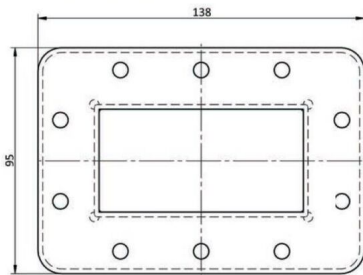

ADDITIONAL INFORMATION

Frequency [MHz]	2450
Output Power CW [W]	30000
Waveguide size	WR340 / R26
Flange	UDR
Product group	Waveguide