

MAGNETRON - 1200223

Category: Magnetrons

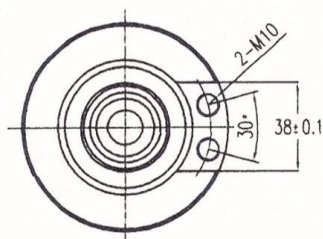

BILDERGALERIE

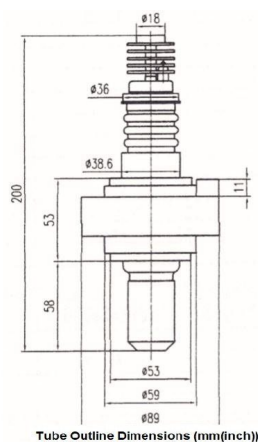
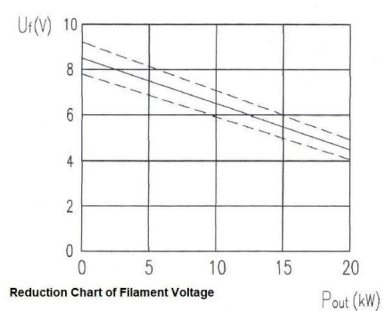

Tube Outline Dimensions (mm(inch))

ADDITIONAL INFORMATION

Typ	Magnetron
OEM Item Number	CK-2091T
Output Power CW [W]	15000
Frequency [MHz]	2450
ISM Band	S-Band
Cooling	air-cooled & water-cooled
Orientation of HV and cooling connectors	-
Fastening / Studs	including pole piece
Orientation HV to fastening	-
Magnet	-
Cooling Connector Type	G1/8" Female Thread
Temperature sensor	-